



California Faucets®

# Spare Parts Diagram

# Descanso®

## Pull-Down Kitchen Faucet with Squeeze Sprayer

- △ A REQUIRES ITEM (3)
- △ B REQUIRES ITEM (25)
- △ C REQUIRES ITEM (23)
- △ D REQUIRES ITEM (17)
- △ E REQUIRES ITEM (24)
- △ F REQUIRES ITEM (8)

K30-100SQ-SL	K30-102SQ-SL
K30-100SQ-KL	K30-102SQ-KL
K30-100SQ-FL	K30-102SQ-FL
K30-100SQ-TL	K30-102SQ-TL
K30-101SQ-SL	K30-103SQ-SL
K30-101SQ-KL	K30-103SQ-KL
K30-101SQ-FL	K30-103SQ-FL
K30-101SQ-TL	K30-103SQ-TL

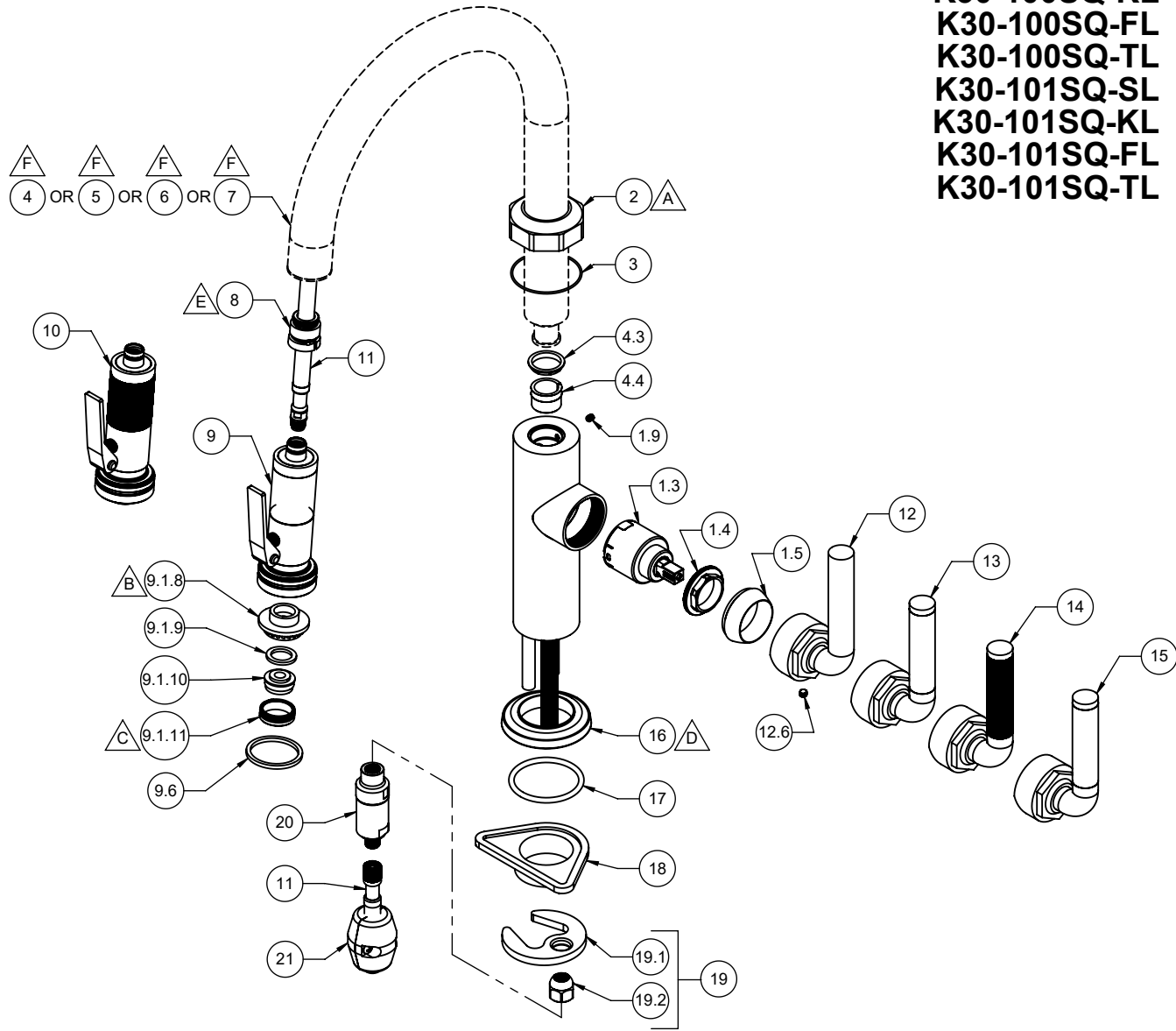
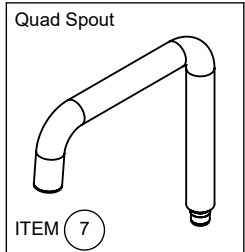
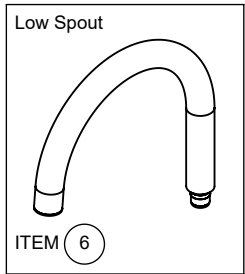
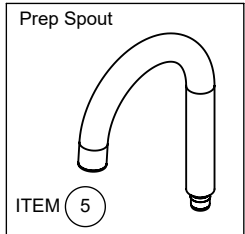
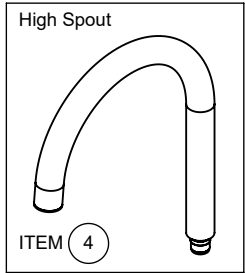

**K30-100SQ-SL K30-102SQ-SL**  
**K30-100SQ-KL K30-102SQ-KL**  
**K30-100SQ-FL K30-102SQ-FL**  
**K30-100SQ-TL K30-102SQ-TL**  
**K30-101SQ-SL K30-103SQ-SL**  
**K30-101SQ-KL K30-103SQ-KL**  
**K30-101SQ-FL K30-103SQ-FL**  
**K30-101SQ-TL K30-103SQ-TL**

To order spare parts add and/or replace as stated below:

**SPD-** prefix added to part number(s)  
**-ZZ** replaced with finish code (see finish table)  
**-WW** replaced with **-90** (light finish) or **-96** (dark finish)

Ex: **SPD-7-100362-PC** or **SPD-86030-96**

	ITEM	PART NO.	DESCRIPTION	QTY.
for SL Series	11	880338-99	HOSE, NYLON BRAIDED (DN6) W/ SILICONE, M10 MT X M10 F X 65" NSF	1
	12	7-100279-ZZ	ASM, INDUSTRIAL KIT LEVER - SMOOTH <i>(incl. 12.6)</i>	1
	12.6	86047-90	SETSCREW 10-24 X 3/16 SCKT HD CONE PT SS	1
for FL Series	13	7-100301-ZZ	ASM, INDUSTRIAL KIT LEVER - CARBON FIBER <i>(incl. 12.6)</i>	1
for KL Series	14	7-100300-ZZ	ASM, INDUSTRIAL KIT LEVER - KNURL <i>(incl. 12.6)</i>	1
for TL Series	15	7-100568-ZZ	ASM, INDUSTRIAL KIT LEVER - TEAK <i>(incl. 12.6)</i>	1
	16	10781-ZZ	BASE RING, INDUSTRIAL KIT	1
	17	87139-80	O-RING Ø44.04 X 3.53 (-224) BUNA-N A70	1
	18	880325-81	SPACER, SINGLE HOLE MOUNTING	1
	19	6-200246	KIT, KITCHEN/H2O DISP MNT HDW <i>(incl. 19.1, 19.2)</i>	1
	19.1	880309-98	MOUNTING BRACKET, SINGLE HOLE CRESCENT	1
	19.2	10552-98	NUT, HEX W/ DOME 7/16-24	1
	20	6-200262	KIT, KITCHEN FAUCET CHECKVALVE - 1.85 GPM FLOW	1
	21	6-200249	KIT, KITCHEN HOSE WEIGHT 310g	1
	23	880567-81	TOOL, SQUEEZE SPRAYER AERATOR	1
	24	880533-81	TOOL, SQUEEZE UPGRADE	1
for ITEM 9.1.8	25	880333-91	KEY, ALLEN 7.0MM, BLACK	1
for ITEM 1.9	26	882042-99	KEY, ALLEN, 5/64", BLACK	1
for ITEM 12.6	27	882043-99	KEY, ALLEN, 3/32", BLACK	1

	ITEM	PART NO.	DESCRIPTION	QTY.
	1.3	880297-99	CART 35MM, SNGL LVR (COLD TO HOT ROTATION)	1
	1.4	10564-98	NUT, 35MM CART KIT PACKING	1
	1.5	10565-ZZ	BONNET, STD KIT	1
	1.9	86031-WW	SETSCREW 8-32 X 3/16 SCKT HD CUP PT SS	1
	2	10783-ZZ	TRIM, OCTAGON KIT BODY	1
	3	87338-80	O-RING Ø46.00 X 1.20 (NA) BUNA-N A70	1
for 100 Series	4	7-100474-ZZ	ASM, 30MM MAIN KIT SPOUT LESS SPRAY INSERT <i>(incl. 4.3, 4.4)</i>	1
	4.3	10558-81	BUSHING, KIT SPT ADPTR	1
	4.4	11297-81	FRICTION RING, KIT SPT ADPTR - G2	1
for 101 Series	5	7-100475-ZZ	ASM, 30MM PREP KIT SPOUT LESS SPRAY INSERT <i>(incl. 4.3, 4.4)</i>	1
for 102 Series	6	7-100476-ZZ	ASM, Ø30MM LOW KIT SPOUT LESS SPRAY INSERT <i>(incl. 4.3, 4.4)</i>	1
for 103 Series	7	7-100477-ZZ	ASM, Ø30MM 2 BEND KIT SPOUT LESS SPRAY INSERT <i>(incl. 4.3, 4.4)</i>	1
	8	6-200299	KIT, DETENT, KITCHEN PULL DOWN	1
for SL, FL, TL Series	9	7-100411-ZZ	ASM, SPRAYER, CONT SQUEEZE PULL DOWN <i>(incl. 9.1.8, 9.1.9, 9.1.10, 9.1.11, 9.6)</i>	1
	9.1.8	11079-81	JET PAD, SQUEEZE SPRAYER	1
	9.1.9	87302-80	WSHR, Ø14.50 X Ø20.50 X 2.0 EPDM A70 (WRAS)	1
	9.1.10	880499-81	INSERT, FULL FLOW, AERATED M24 FLAT	1
	9.1.11	11080-ZZ	SHELL, SQUEEZE SPRAYER AERATOR	1
	9.6	87287-80	O-RING Ø32.99 X 2.62 (-125) BUNA-N A70 SQUARE	1
for KL Series	10	7-100412-ZZ	ASM, SPRAYER, KNURL SQUEEZE PULL DOWN <i>(incl. 9.1.8, 9.1.9, 9.1.10, 9.1.11, 9.6)</i>	1